



WSAA PRODUCT APPRAISAL CERTIFICATE

Reece Australia Pty Ltd DIMAX Ductile Iron Fittings

This Appraisal is for a range of polymeric coated ductile iron fittings manufactured to AS/NZS 2280:2020 *Ductile iron pipes and fittings*.

The range includes PN16 and PN35 bends, tees, tapers and connectors in sizes from DN 80 to DN 300 with various socket, flange and spigot configurations.

This Issue 4 is to add additional fittings to the range including pre-tapped connectors that comply with the revised requirements of AS/NZS 2280:2020 Amdt 1:2021.

A listing of Quality and Product Certificates, details of products and supplier contacts are included in the attached Schedules A, B and C.

Product Category	Ductile Iron Fittings
PA Number:	PA 1924 Issue 4
Supplier	Reece Australia Pty Ltd
Brand	DIMAX
Standards	AS/NZS 2280:2020 <i>Ductile iron pipes and fittings</i>
WSAA Product Specification	WSA PS 201 <i>Ductile Iron Fittings (CIOD) for Pressure and Non-Pressure Applications – Drinking Water, Non-Drinking Water Supply and Sewerage</i>
Issue date	6 August 2024
Expiry date	7 March 2027
Recommendations	It is recommended that WSAA members and associates accept or authorise DIMAX DI fittings, as detailed in the Appraisal Report, for use in water supply and sewerage pressure pipelines, provided they are installed in accordance with applicable WSAA Codes and the manufacturer's requirements, where specified.
Disclaimer	The disclaimer on Page 2 explains a number of very important limits on your ability to rely on the information in this Product Appraisal Certificate and the assessment criteria used to underlay it. Please read it carefully and take it into account when considering the content in this Certificate.

1. Disclaimer

This Product Appraisal Certificate (Certificate) is issued by WSAA on the understanding that:

This Certificate applies to the product(s) as submitted in Schedule A. Any changes to the product(s) either minor or major shall void this Certificate.

To maintain the recommendations of this Certificate any such changes shall be detailed and notified to the Product Appraisal Manager for consideration and review of the Certificate including the product appraisal criteria underlying it and appropriate action. Appraisals and their recommendations will be the subject of continuous review dependent upon the satisfactory performance of products.

WSAA reserves the right to undertake random audits of product manufacture and installation. Where products fail to maintain appraised performance requirements the appraisal and its recommendations may be modified and reissued. Certificates will be reviewed and reissued at regular intervals not exceeding five (5) years.

WSAA reserves the right to withdraw this Certificate at any time in its sole and absolute discretion for any reason.

The following information explains a number of very important limits on your ability to rely on the information in this Certificate. Please read it carefully and take it into account when considering the contents of this Certificate.

Any enquiries regarding this Certificate should be directed to the Product Appraisal Manager Phone: 03 8605 7601 email carl.radford@wsaa.asn.au.

1.1. Issue of Certificate

This Certificate has been published and/or prepared by WSAA and nominated Project Manager and peer group of technical specialists (the Publishers).

The Certificate and the underlying product appraisal criteria have been prepared for use within Australia only by technical specialists that have expertise in the function of products such as those appraised in the Certificate (the Recipients).

By accepting this Certificate, the Recipient acknowledges and represents to the Publisher(s) and each person involved in the preparation of the Certificate and product appraisal criteria underlying it that the Recipient has understood and accepted the terms of this Disclaimer.

1.2. Limits on Reliance on Information and Recommendations

1.2.1. Disclaimer of liability

Neither the Publisher(s) nor any person involved in the preparation of the Certificate and product appraisal criteria underlying it accept(s) any liability for any loss or damage suffered by any person however caused (including negligence or the omission by any person to do anything) relating in any way to the Certificate or the product appraisal criteria underlying it. This includes (without limitation) any liability for any recommendation or information in the Certificate or any errors or omissions.

1.2.2. Intellectual Property and other rights

WSAA does not undertake any assessment of whether the importation, manufacture, sale or use of the Product the subject of this Certificate infringes the intellectual property rights or proprietary rights of any person. Recipients of the Certificate should undertake their own assessment of whether (as relevant) the importation, manufacture, sale or use of the relevant Products infringe the intellectual property rights or other proprietary rights of any person. If the Product infringes intellectual property rights or other proprietary rights there is potential for the supply of the Products to be interrupted.

From time to time WSAA and the other Publishers may receive notice of allegations that the importation, manufacture, sale or use of the Product infringes intellectual property rights or other proprietary rights. WSAA's policy is to not refer to such allegations in its Certificate or take any other steps to put Recipients on notice of such allegations. If, however, WSAA becomes aware that the allegations have been admitted or proved in Court, then WSAA may, at its discretion, take such steps as it considers appropriate. As such, Recipients acknowledge, agree and accept that WSAA may have information in its possession about intellectual property rights infringement allegations or other infringement allegations in relation to the Product which are not referred to or disclosed in this Certificate and which are not otherwise communicated to Recipients.

1.2.3. Need for independent assessment

The information and any recommendation contained (expressly or by implication) in this Certificate are provided in good faith (and subject to the limitations noted in this Certificate). However, you should treat the information as indicative only. You should not rely on that information or any such recommendation except to the extent that you reach an agreement to the contrary with the Publisher(s).

This Certificate does not contain all information that a person might require for the purposes of assessing any product discussed or appraised within it. The product appraisal criteria used in preparing this Certificate may not address all relevant aspects of the Product.

Recipients should seek independent evidence of any matter which is material to their decisions in connection with an assessment of the Product and consult their own advisers for any technical information required. Any decision to use the Product should take into account the reliability of that independent evidence obtained by the Recipient regarding the Product. Recipients should also independently verify and assess the appropriateness of any recommendation in the Certificate, especially given that any recommendation will not take into account a Recipient's particular needs or circumstances.

WSAA has not evaluated the extent of the product liability and professional indemnity insurance that the provider of the product maintains. Recipients should ensure that they evaluate the allocation of liability for product defects and any professional advice obtained in relation to the product or its specification including the requirements for product liability and professional indemnity insurance.

1.3. No Updating

Neither the Publisher(s) nor any person involved in the preparation of this Certificate or the product appraisal criteria underlying it [has] [have] any obligation to notify you of any change in the information contained in this Certificate or of any new information concerning the Publisher(s) or the Product or any other matter.

1.4. No Warranty

The Publisher(s) do[es] not, in any way, warrant that steps have been taken to verify or audit the accuracy or completeness of the information in this Certificate, or the accuracy, completeness or reasonableness of any recommendation in this Certificate

QUALITY AND PRODUCT CERTIFICATIONS

Copies of the following Quality Certificates are available from WSAA.

**TABLE A1
HIMGIRI CASTINGS PVT LTD - MANAGEMENT SYSTEMS**

Plot 213 Chanrapura Village Taluka Halol District Panchmahal Gujarat	
Quality Systems Standard	ISO 9001:2015
Certification Licence No.	99 100 11786
Certifying Agency	TUV SUD
First Date of Certification	23 June 2010
Current Date of Certification	2 November 2023
Expiry Date of Certification	1 November 2026

**TABLE A2
REECE AUSTRALIA PTY LTD - PRODUCT CERTIFICATION**

118-123 Burwood Hwy Burwood Vic	
Product Standard/Spec.	AS/NZS 2280:2020
Certificate No.	SMK26703
Issuing Certification Body	Intertek SAI-Global
First Date of Certification	26 October 2021
Current Date of Certification	19 July 2024
Expiry Date of Certification	25 October 2026



PRODUCT LITERATURE

**TYTON® JOINT FITTINGS
DUCTILE IRON SYSTEMS DN100 - 300**

Designed and Manufactured to AS/NZS 2280



OVERVIEW

Dimax Ductile Iron fittings offer high strength and impact resistance.

It is suitable for both 'above ground' and 'in ground' installations.

All Dimax fittings are manufactured with a high quality thermally bonded polymeric coating for superior corrosion protection and service life.

The TYTON® socket profile provides the flexibility of using TYTON® gaskets for ductile iron OD compatible pipes, PLASTYT gaskets for series 1 PVC pipes or TYTON-LOK® gaskets for restrained joints.

Joints can be deflected and permits axial movement to compensate for thermal expansion and contraction. DN100 - 300 has an allowance for 5 degrees maximum deflection.

All flange dimensions comply with AS/NZS 4087

Uses a single cast manufacturing method for optimal strength.

DESCRIPTION

Dimax TYTON® JOINT fittings are manufactured to AS/NZS 2280. The Dimax range of fittings continues to grow, adding sizes and configurations for pipeline construction in both above and below ground applications.

GENERAL APPLICATION

TYTON® JOINT offer a secure push joint installation with a small amount of deflection to allow for axial movement. Socketed Ductile Iron Fittings are commonly used in below ground applications such as a water trunk main branches.

TECHNICAL DATA

Size Range
DN 100 - DN 300

Allowable Operating Pressure
1600 or 3500kPa

Maximum Temperature
70° for water and most neutral liquids

Certification
AS/NZS 2280 – Ductile Iron Pipes & Fittings
AS/NZS 4020 – Testing for use in contact with drinking water
AS/NZS 4087 - Flange dimensions to Australian standards



Revision Date: NOV 21



DIMAX FLANGED FITTINGS DUCTILE IRON SYSTEMS DN80 - 300

Designed and Manufactured to AS/NZS 2280
Flange Dimensions to AS/NZS 4087



OVERVIEW

Dimax Ductile Iron fittings offer high strength and impact resistance.

It is suitable for both 'above ground' and 'in ground' installations.

All Dimax fittings are manufactured with a high quality thermally bonded polymeric coating for superior corrosion protection and service life.

Flange joints are self anchoring and don't require external anchorages.

Uses a single cast manufacturing method for optimal strength.

All flange dimensions comply with AS/NZS 4087.

Alternate flange dimensions are available on request.

DESCRIPTION

Dimax high strength Ductile Iron Flanged Fittings are available in an ever growing range of sizes and configurations for pipeline construction in both above and below ground applications.

GENERAL APPLICATION

Dimax Flanged Fittings are used to provide restrained non-flexible joints in pipelines or as part of a pipework arrangement. Flanged Ductile Iron Fittings are commonly used in above ground applications such as a water treatment plant and pump stations.

TECHNICAL DATA

Size Range
DN 80 - DN 300

Allowable Operating Pressure
1600kPa

Maximum Temperature
70° for water and most neutral liquids

End Connection
Flanged to AS/NZS 4087

Certification
AS/NZS 2280 – Ductile Iron Pipes & Fittings
AS/NZS 4020 – Testing for use in contact with drinking water
AS/NZS 4087 - Flange dimensions to Australian standards



Revision Date: NOV 21



DIMAX MaxiTap™ Connector Quad Connector

Designed and Manufactured to AS/NZS 2280



RANGE OVERVIEW

Four (Quad) outlet option

DR brass plugs to allow use of 1, 2, 3 or 4 ports

Brass Bush and Plugs available in 3/4" and 1" plugs options eliminating the need for drilling and tapping on-site

Unused outlets are fitted with removable DR Brass Plug

Allows for complete installation of household services at the time of pipeline construction

Avoids the need for future disturbances of the main and its environment therefore eliminating the risk of pipeline damage

Avoids inefficient and costly excavation of pipeline to connect household services after installation

Avoids the undesirable practice of drilling holes in new pipes

Ductile Iron fitting for high strength and impact resistance

Thermal bonded polymeric coating to AS/NZS 4158

Utilises TYTON® or TYTONLOK jointing system

DESCRIPTION

DIMAX MaxiTap™ Connectors are fully encapsulated (inside & out) in a fusion bond epoxy coating allowing for maximum corrosion protection in all soil types whilst safely conveying potable water to households.

In full compliance with the latest version of AS2280, MaxiTap™ Connector tapping points are easily exchangeable DR Brass inserts allowing for multiple thread sizes whilst ensuring the Ductile Iron body coating remains completely intact and is not compromised by thread cutting from the manufacturer.

The DR Brass inserts are also sold separately to allow for stocking of one body and multiple inserts which can then be quickly adapted to suit any particular site requirements.

GENERAL APPLICATION

The MaxiTap™ system provides for complete installation of house services at the time of pipeline construction minimising the need for future drilling and tapping.

TECHNICAL DATA

Size Range
DN 100 & DN 150

Offtakes
3/4" and 1"

Allowable Operating Pressure
1600 kpa

Maximum Temperature
Max design temperature = 70°C
AS4020 Temperature = 40°C

End Connections
TYTON® Socket

Coating
Fusion Bonded Polymeric
Coating to AS4158



DIMAX MaxiTap™ Connector Quad Connector

Designed and Manufactured to AS/NZS 2280

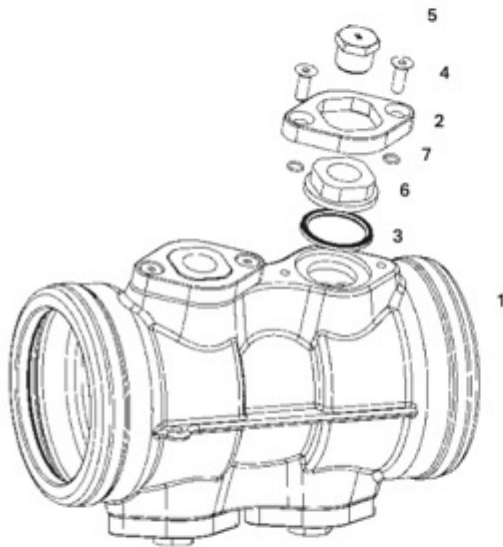

Item	Description	Qty	Material
1	DN100 DIMAX TAPPED CONNECTOR	1	SGI AS1831-400/15
2	DI TOP PLATE-FUSION COATED	4	SGI AS1831-400/15
3	BRONZE BUSH GASKET	4	EPDM AS1646/70-75 DURO
4	COUNTERSUNK CAP SCREW	8	SS ASTM A276-316
5	BRASS PLUG	3	DZR AS1567-C35200
6	TAPPED BRONZE BUSH	4	LGM AS1565-CB3600
7	O RING	8	AS1646 - NBR - BS 012

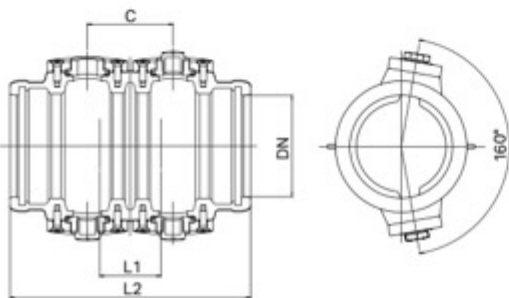

Nominal Size	Dimensions			Outlet Size *		No. of Outlets	Weight
	L1	L2	C	Imperial	Metric		
100	75	295	105	¾"	20 mm	4	9.5 kg
100	75	295	105	1"	25 mm	4	9.5 kg
150	75	315	105	¾"	20mm	4	14 kg
150	75	315	105	1"	20mm	4	14 kg

* Brass Bush and DR Plug kits available to interchange between ¾" and 1" offtakes if required.

DISCLAIMER

All trademarks and logos are owned by The Reece Group. The words TYTON®, TYTON-LOK® and TYTON JOINT® are United States Pipe and Foundry Co. Inc. trademarks and are registered as such in the United States Patent Office and some 45 other countries. Viadux is an exclusively authorised and licensed user of these trademarks within Australia and New Zealand. All other brand or product names are trademarks or registered marks of their respective owners. Because we are continuously improving our products and services, The Reece Group reserves the right to change specifications without prior notice.

Call 1800 032 566 or visit www.reece.com.au/storefinder for your nearest branch.

CERTIFICATIONS

AS/NZS 2280 – Ductile Iron Pipe & Fittings
Licence No. WMK26703 | SMK26703
AS/NZS 4020 – Tested for use in contact with drinking water





SUPPLIER CONTACTS

Reece Australia Pty Ltd

118 Burwood Highway

Burwood Vic 3125

Web: <https://www.reece.com.au/civil>

Contacts:

Jason Hall

Mobile: 0448 107957

Email: jason.hall@reece.com.au

Charles Cauchi

Mobile: 0429 926488

Email: charles.cauchi@reece.com.au

Reece Civil Stores:

Website store locator: <https://www.reece.com.au/aboutus/contactus>